

GENERAL NOTES:

- REFER TO STRUCTURAL ENGINEERS DRAWINGS FOR DETAILS OF FOOTINGS, SLABS, STAIR AND RAMP DETAILS, AND ALL OTHER STRUCTURAL DETAILS.
- REFER TO CIVIL ENGINEERS DRAWINGS FOR ROADWORKS, FINISHES TO ROADS AND CARPARKS, SETOUTS AND ROAD DETAILS, PAVED AREAS AND FINISHED EXTERNAL LEVELS.
- REFER TO LANDSCAPE ARCHITECTS DRAWINGS FOR ALL LANDSCAPE WORKS, SETOUT OF FOOTPATHS, PAVED AREAS, FINISHED PAVING LEVELS AND PLANTING.
- REFER TO LANDSCAPE ARCHITECTS DRAWINGS AND SPECIFICATION FOR DETAILS OF EXISTING TREES TO BE RETAINED.
- REFER TO HYDRAULIC ENGINEERS DRAWINGS AND SPECIFICATION FOR ALL HYDRAULIC DETAILS.
- REFER TO CIVIL AND HYDRAULIC ENGINEERS DRAWINGS FOR ALL STORMWATER AND DRAINAGE DETAILS.
- REFER TO ELECTRICAL ENGINEERS DRAWINGS AND SPECIFICATION FOR ALL DETAILS OF EXTERNAL LIGHTING, POWER, DATA AND ELECTRICAL EQUIPMENT.
- REFER TO MECHANICAL ENGINEERS DRAWINGS AND SPECIFICATION FOR DETAILS OF MECHANICAL DUCTWORK AND EQUIPMENT.
- REFER TO SIGNAGE AND GRAPHICS DESIGNERS DRAWINGS FOR DETAILS OF ALL SIGNAGE.
- ALL DOORS TO HAVE 100mm LONG NIB UNLESS OTHERWISE NOTED

NOTES - SITE PLAN:

- REFER TO DRAWINGS A120-A147 FOR DETAILS RESIDENTIAL ACCOMMODATION.
- REFER TO DRAWINGS A170-A195 FOR DETAILS OF ADMINISTRATION AND LIBRARY EXTENSION.
- REFER TO DRAWINGS A200-213 FOR DETAILS CLASSROOM, SYNDICATE, SENIOR COMMON AND DINING BLOCK.

RESIDENTIAL ACCOMMODATION BUILDINGS

- R11 BEDROOM
- R12 ENSUITE
- R13 STAIRS
- R14 LIFT
- R18 HOT WATER PLANT ROOM

ADMINISTRATION BUILDING

- A19 STAFF COMMON ROOM
- A20 DIRECTOR ACADEMIC PROGRAMS
- A21 FACILITY OFFICE
- A22 MEETING ROOM
- A23 DEPUTY DIRECTOR ACADEMIC PROGRAMS
- A24 UTILITY ROOM
- A25 MALE/FEMALE AMENITIES
- A26 LOBBY
- A27 BOARD ROOM
- A28 DIRECTOR EXECUTIVE
- A29 EXECUTIVE ASSISTANT
- A30 LIFT
- A31 OFFICE
- A32 DIRECTOR CORPORATE
- A33 EXECUTIVE WAITING

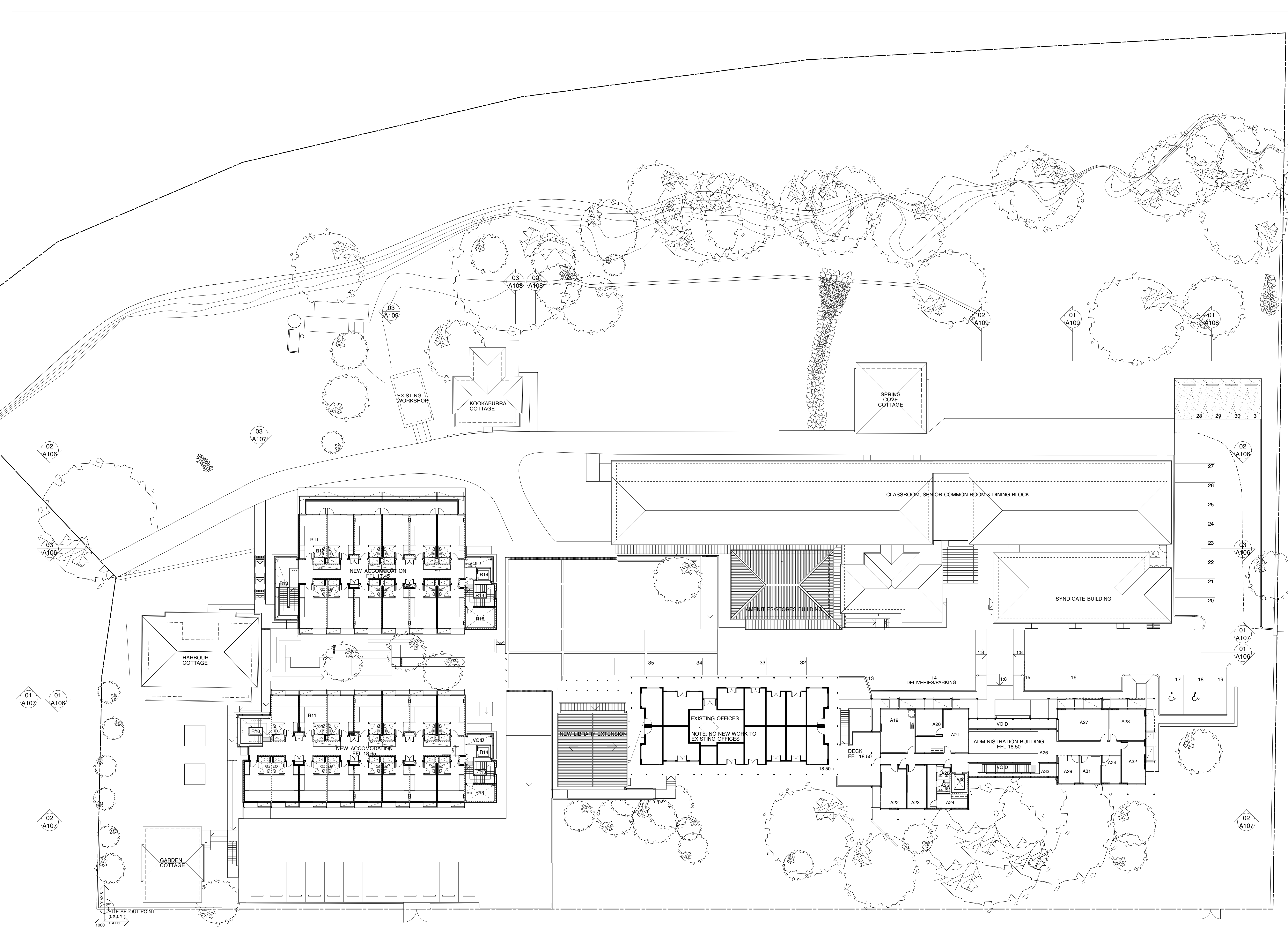

P	13/8/09	ISSUED FOR TENDER
O	20/7/09	CONSULTANTS ISSUE
N	16/7/09	ISSUED FOR INFORMATION
M	14/7/09	CONSULTANTS ISSUE
L	10/7/09	ISSUED TO CONSULTANTS
K	09/07/09	ISSUED TO CONSULTANTS
J		ISSUED FOR INFORMATION
I	29/5/09	CONSULTANTS ISSUE
DATE		REVISION

NOTE: DO NOT SCALE FROM DRAWING. USE FIGURED DIMENSIONS ONLY. CHECK ALL DIMENSIONS ON SITE BEFORE ANY MANUFACTURE OR CONSTRUCTION.

AUSTRALIAN INSTITUTE OF POLICE MANAGEMENT

CLIENT: AUSTRALIAN FEDERAL POLICE

SITE LEVEL 1 PLAN

brewster horth architects
First Floor
85 Commonwealth St, Surry Hills NSW 2010
T 02 8231 7100 F 02 8231 7101 brewsterhorth.com.au

PROJECT #	20816	DWG	REV
DATE	13 AUG 2009		
SCALE	1:200	A104	P
DESIGNER	CD	CHKD	VR

© Copyright of Brewster Horth Pty Limited. 2009. ACN 002 513 153. All rights reserved. Figured dimensions shall be taken in preference to scaling. The Contractor shall check all dimensions on site before commencing work. Brewster Horth Architects is a division of Brewster Horth Pty Limited.